



型号 (Model)

## B-1300(MS308-2)



## B-1301(MS308-3)



1. 材质 :304 不锈钢
2. 表面处理: 拉丝, 抛光
3. 功能及用途: 适应单点闭锁, 可供两点、三点锁闭使用。实现左、右开启功能, 旋转 90 度。

1. Material: 304 stainless steel
2. Surface treatment: brushed, polishing
3. Function and use: It is suitable for single-point locking, and can be used for two-point and three-point locking. Realize the left and right opening function, rotate 90 degrees.

### B-1300(MS308-2) 尺寸 Size

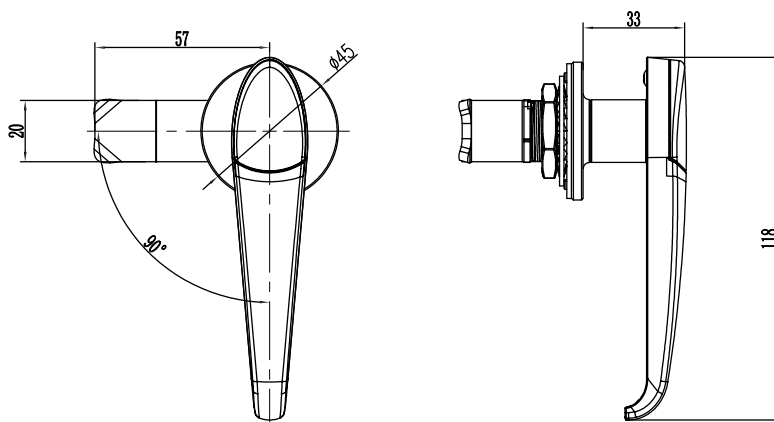

### B-1301(MS308-3) 尺寸 Size

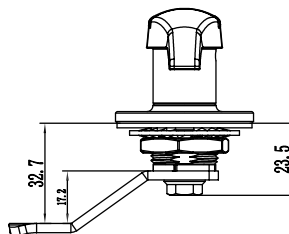
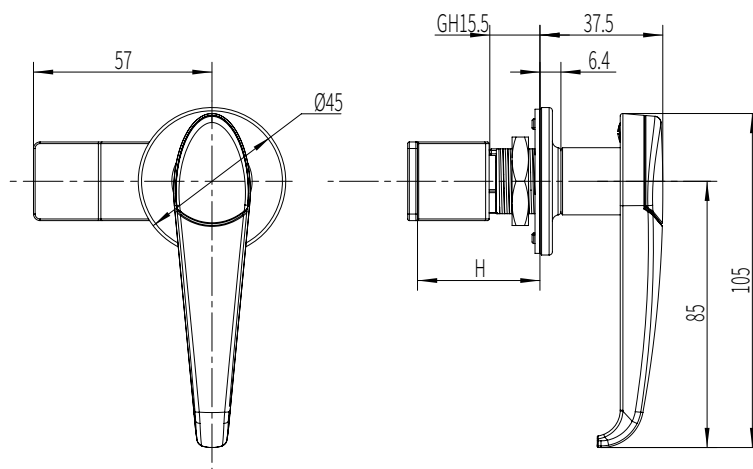

Note: Rotate left and right by changing the orientation of the positioning piece.

| Type selection | Universal | Exclusive |
|----------------|-----------|-----------|
| Long handle    | B-1300-1  | B-1300-2  |
| Short handle   | B-1301-1  | B-1301-2  |

